

EPK SERIES

LABELLING HEADS
HIGH SPEED APPLICATION

OPTIONALS / ACCESSORI

FULL COLUMN / COLONNA CON MOVIMENTO

SUPPORT FOR HP PRINTING / SUPPORTO PER STAMPA HP

ULTRASONIC LABEL SENSOR* / FOTOCELLULA ULTRASUONI*

* For clear label / Per etichette trasparenti

76 MM CORE ADAPTOR / ADATTATORE BOBINA 76 MM

ENCODER / ENCODER

PREEND OF LABEL / PREFINE BOBINA

CASTER / RUOTE

LAMP ALARM / ALLARME VISIVO

The list of optionals may be changed / La lista degli accessori può subire modifiche

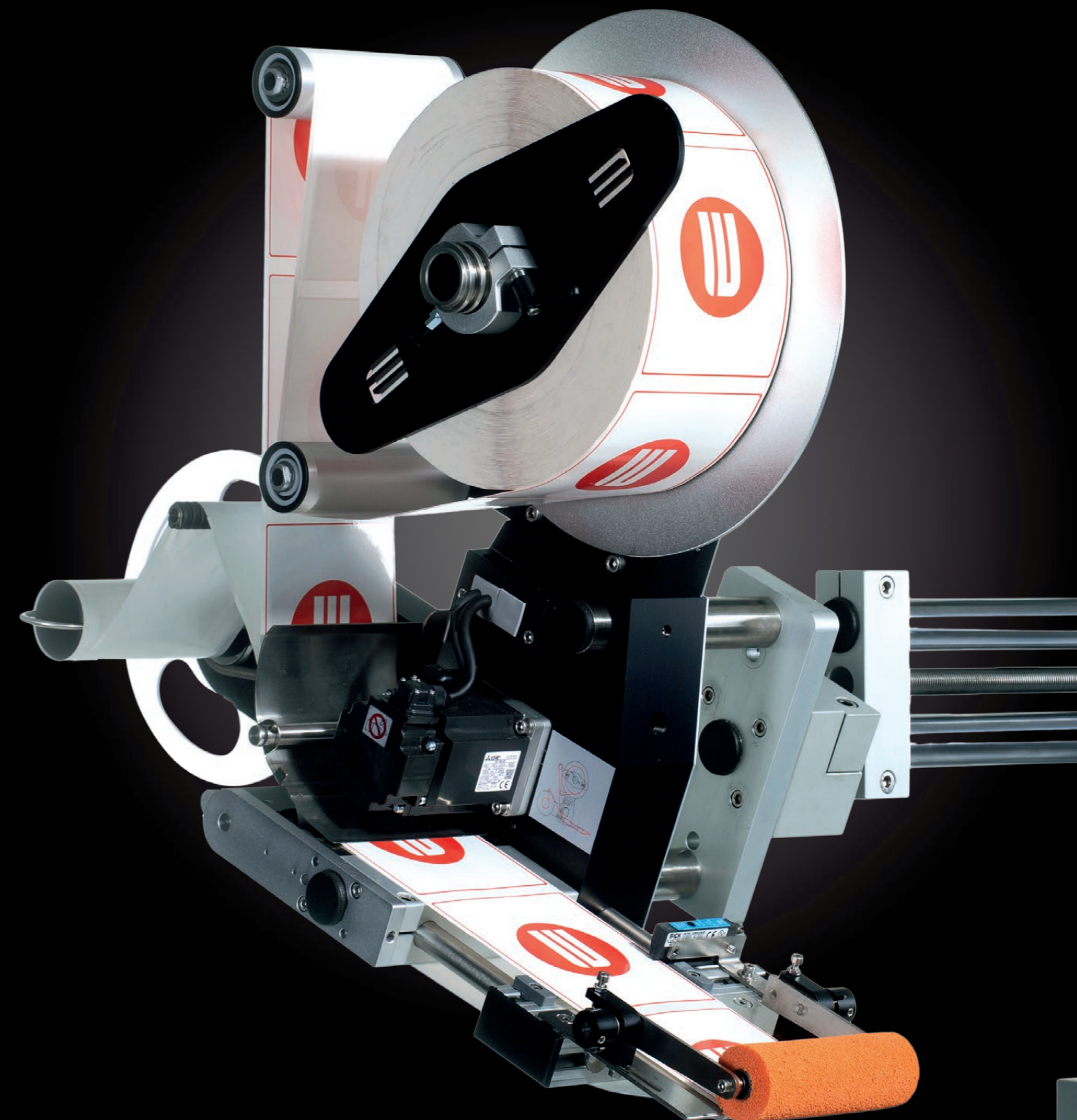

EPK SERIES

LABELLING HEADS HIGH SPEED APPLICATION

Automatic self-adhesive label applicators to be installed on production lines, perfect for the application of upper, side and bottom self-adhesive labels. The use of brushless motors ensures high reliability and precision. All running parameters can be set by a touch screen control unit and 50 recipes can be saved on it.

TESTE ETICHETTATRICI AD ALTA VELOCITÀ

Applicatori automatici di etichette auto-adesive da abbinare a linee di produzioni, ideale per l'applicazione di etichette autoadesive superiore, inferiore e di lato. L'utilizzo di motori brushless garantisce alta affidabilità e precisione. Una centralina con controlli touch permette di settare tutti i parametri di funzionamento e di salvare 50 ricette.

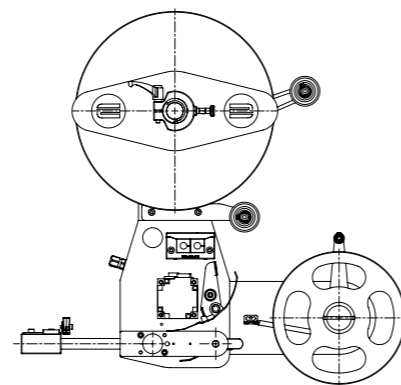

LEFT VERSION

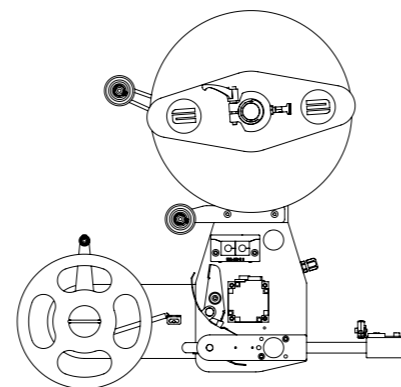

RIGHT VERSION

EPK SERIES

EPK 120

EPK 160

EPK 220

| | | | |
|------------------------|---|--------|--------|
| LABEL WIDTH | 120 mm | 160 mm | 220 mm |
| LABELS LONG MAX | 500 mm | | |
| INTERNAL CORE DIAMETER | 38 mm (76 mm with adaptor) | | |
| LABELS ROLL DIAMETER | 300 mm | | |
| POWER SUPPLY | 220 or 110 V 50/60 Hz | | |
| WATT | 200 W | | |
| SPEED | 60-70 m/min (label dimension and roll weight can modify it) | | |

DIMENSIONS

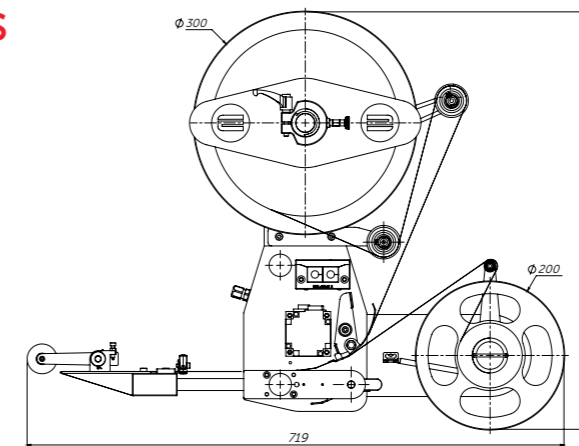

LABELS APPLICATION

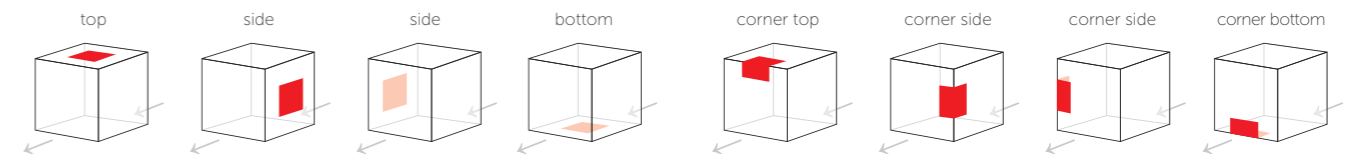

EPK SERIE IN ACTION

